

P SERIES

ROT DN33

FIRE HOSE REEL

Model: PT33/20 - PT33/30



R.I.A. Swivel Rotating:

- R.I.A. compliant with Standard NF EN 671-1 and regulations for products construction EU no. 305/2011.
- Meets the requirements of the installation rule of the French Standard NFS 62-201.
- Manufactured in tube and sheet steel with epoxy resin coating oven-cured polyester.
- Manufactured in 304 L stainless steel tube and sheet with electrolytic polishing. (R.I.A. stainless steel)
- Simple and robust design allowing great ease of assembly and maintenance.
- Composite DMA or brass diffuser valve.
- Aluminum water box and brass diffuser faucet. (Reinforced R.I.A.)
- Mounting: The removable wall bracket is sealed directly to the front wall substation assembly and connection.
- Maintenance: Verification, dismantling, etc., interventions may be carried out with the shut-off valve under pressure, it is therefore not necessary to isolate and drain all or part of the installation.

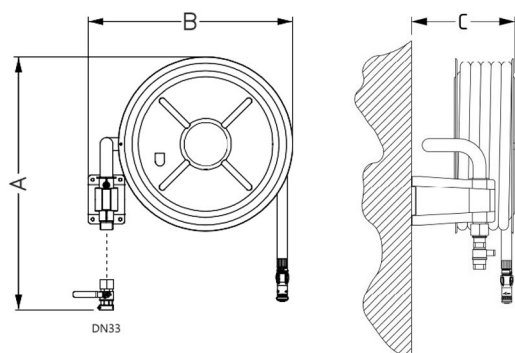

technical features

FEATURES	TYPE >	PT 33/20 DMA	PT 33/30 DMA
Article code		09000412 brass nozzle: 09000411 stainless steel: 99150020 reinforced: 09000451	09000402 brass nozzle: 09000401 stainless steel: 99150030 reinforced: 09000441
Ø nominale		33mm	
Hose length		20 m	30 m
Dimensions in mm:			
Height	A	655	
Width	B	700	
Depth	C	445	
Connection	D	1" 1/2 M	
Effective reach (meters)	Straight jet	13,3	
at 0,2 Mpa on the shut-off valve	Diffused jet	3,4	
Unloaded weight		30 Kg	38 Kg
Certificate N.F. EN 671-1		RC/02/003 stainless steel : RC/02/004	

Bhia » Ref®

301192

301005



Company registered
in ANEPC nº 712/12

